

TEST REPORT

Report No.: BCTC2504902986-2E

Applicant: Shenzhen Huafurui Technology Co., Ltd.

Product Name: Smartphone

Test Model: P90

Tested Date: 2025-04-07 to 2025-06-11

Issued Date: 2025-06-12

Shenzhen BCTC Testing Co., Ltd.



Product Name: Smartphone

Trademark: CUBOT

Model/Type reference: P90

Prepared For: Shenzhen Huafurui Technology Co., Ltd.

Address: Unit 601-03, 6/F, Block A, Building 1, Ganfeng Technology Building, No. 993 Jiaxian Road, Xiangjiaotang Community, Bantian Street, Longgang District, Shenzhen, P.R. China

Manufacturer: Shenzhen Huafurui Technology Co., Ltd.

Address: Unit 601-03, 6/F, Block A, Building 1, Ganfeng Technology Building, No. 993 Jiaxian Road, Xiangjiaotang Community, Bantian Street, Longgang District, Shenzhen, P.R. China

Prepared By: Shenzhen BCTC Testing Co., Ltd.

Address: 1-2/F., Building B, Pengzhou Industrial Park, No.158, Fuyuan 1st Road, Zhancheng, Fuhai Subdistrict, Bao'an District, Shenzhen, Guangdong, China

Sample Received Date: 2025-04-07

Sample tested Date: 2025-04-07 to 2025-06-11

Issue Date: 2025-06-12

Report No.: BCTC2504902986-2E

Test Standards: EN IEC 62680-1-3:2022

Test Results: PASS

Tested by:

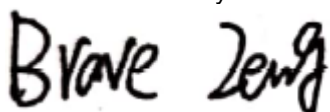

Brave Zeng/ Project Handler

Approved by:



Zero Zhou/Reviewer

The test report is effective only with both signature and specialized stamp. This result(s) shown in this report refer only to the sample(s) tested. Without written approval of Shenzhen BCTC Testing Co., Ltd, this report can't be reproduced except in full. The tested sample(s) and the sample information are provided by the client.

Table Of Content

Test Report Declaration	Page
1. Version	4
2. Test Summary	5
3. Product Information And Test Setup	6
3.1 Product Information	6
3.2 Product Type-C Connector Information	6
3.3 Device Info Capabilities	7
3.4 Block Diagram Of Test Setup	10
4. Test Facility And Test Instrument Used	11
4.1 Test Facility	11
4.2 Test Instrument Used	11
5. Functional Tests Result Summary	12
6. EUT Photographs	14
7. EUT Test Setup Photographs	16

(Note: N/A Means Not Applicable)

BCTC
3C
PPR
Report

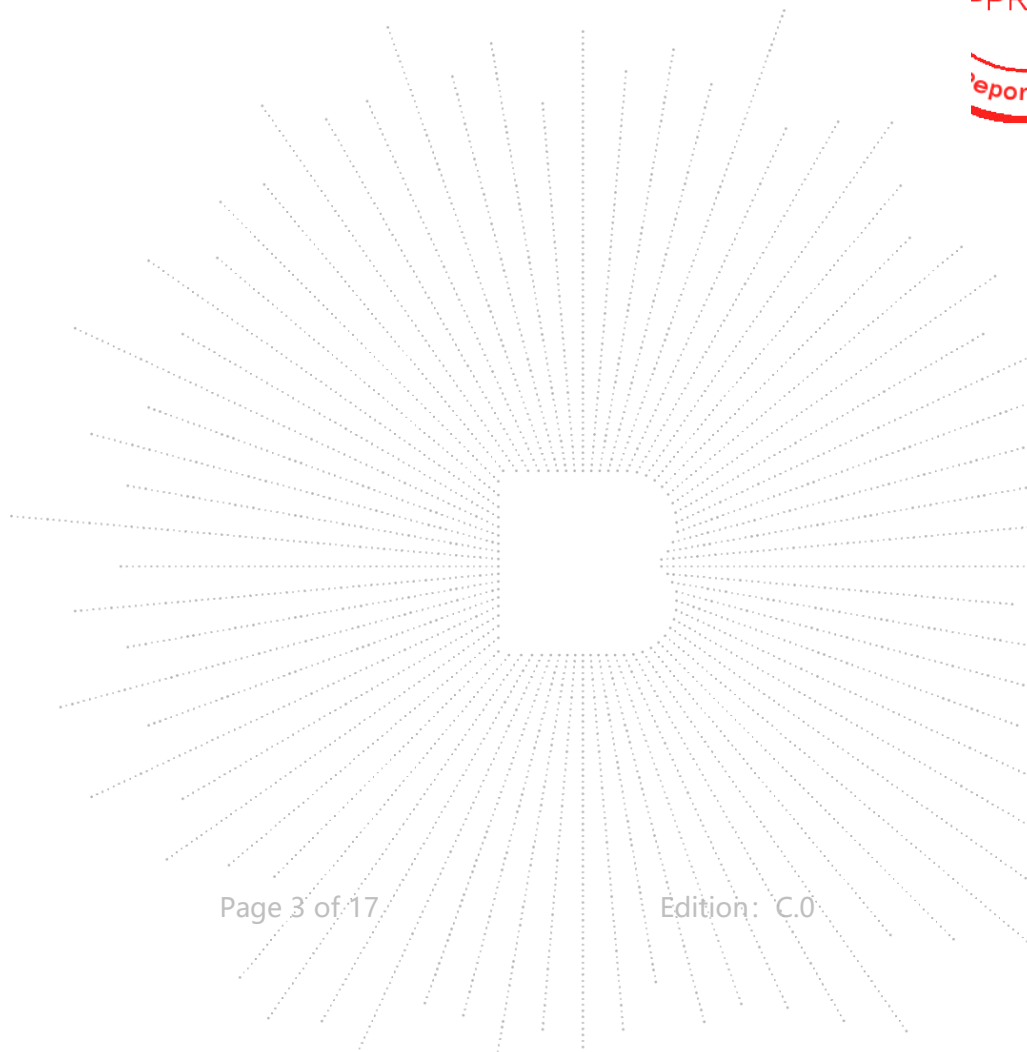

1. Version

Report No.	Issue Date	Description	Approved
BCTC2504902986-2E	2025-06-12	Original	Valid

TEST
TC
OVER
t See

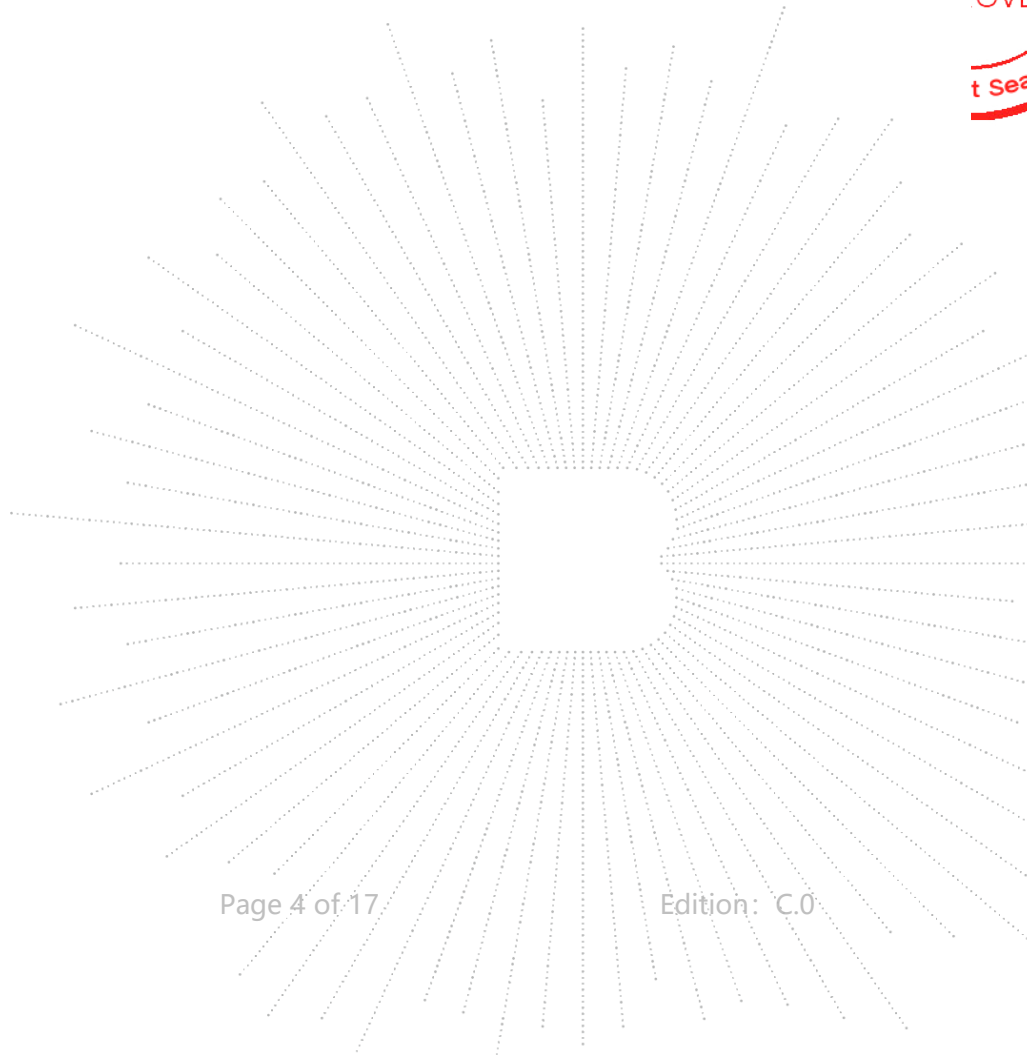

2. Test Summary

The Product has been tested according to the following specifications:

No.	Test Description	Clause No.	Results
1	USB Type-C™ Functional	4	PASS



3. Product Information And Test Setup

3.1 Product Information

Model/Type Reference:	P90
Model Difference:	N/A
Hardware Version:	3368D-MC-V1.1
Software Version:	CUBOT_P90_F021C_V01
Ratings:	DC 9V from adapter/DC 3.87V from battery
Adapter 1 Information:	Model: HJ-PD18W-EU Input: 100-240V~ 50/60Hz 0.6A Output: 5.0V = 3.0A 15.0W OR 9.0V = 2.0A 18.0W OR 12.0V = 1.5A 18.0W MAX
Adapter 2 Information:	Model: TPD-203A120167VF01 Input: 100-240V~ 50/60Hz 0.6A Output: 5.0V = 3.0A 15.0W or 9.0V = 2.22A 19.98W or 12.0V = 1.67A 20.04W

3.2 Product Type-C Connector Information

Product Name:	TYPE C 16P DOUBLE SHELL SINKING PLATE CONN
Model Name:	UB16-81421L18
Company Name:	DONGGUAN QUANSHENG TONG PRECISION COMPONENTS CO.,LTD.
Number of Pins:	16
Reference Test Report:	Test Report No.: 24T04N002978-001-COM Test Laboratory: SAICT, Shenzhen Academy of Information and Communications Technology Issued Date: 2024/12/19

CO.,LTD.

3.3 Device Info Capabilities

Parameter	Vendor Info File
Port_Label	0
Connector_Type	Type-C®
USB4_Supported	NO
USB_PD_Support	YES
PD_Port_Type	DRP
Type_C_State_Machine	DRP
Port_Battery_Powered	YES
BC_1_2_Support	None
Captive_Cable	NO
PD_Spec_Revision_Major	3
PD_Spec_Revision_Minor	1
PD_Spec_Version_Major	1
PD_Spec_Version_Minor	8
PD_Specification_Revision	Revision 3
SOP_Capable	YES
SOP_P_Capable	NO
SOP_PP_Capable	NO
SOP_P_Debug_Capable	NO
SOP_PP_Debug_Capable	NO
Manufacturer_Info_Supported_Port	YES
Manufacturer_Info_VID_Port	29CF
Manufacturer_Info_PID_Port	5081
Chunking_Implemented_SOP	YES
Unchunked_Extended_Messages_Supported	NO
Security_Msgs_Supported_SOP	NO
Unconstrained_Power	NO
Num_Fixed_Batteries	1
Num_Swappable_Battery_Slots	0
ID_Header_Connector_Type_SOP	USB Type-C® Receptacle
USB_Comms_Capable	YES
DR_Swap_To_DFP_Supported	YES
DR_Swap_To_UFP_Supported	YES
VCONN_Swap_To_On_Supported	NO
VCONN_Swap_To_Off_Supported	NO
Responds_To_Discov_SOP_UFP	YES
Responds_To_Discov_SOP_DFP	YES
Attempts_Discov_SOP	YES
Power_Interruption_Available	No Interruption Possible
Data_Reset_Supported	NO
Enter_USB_Supported	NO
Type_C_Can_Act_As_Host	YES
Type_C_Can_Act_As_Device	YES
Type_C_Implements_Try_SRC	NO
Type_C_Implements_Try_SNK	YES

Parameter	Vendor Info File
Type_C_Supports_Audio_Accessory	YES
Type_C_Is_VCONN_Powered_Accessory	NO
Type_C_Is_Debug_Target_SRC	YES
Type_C_Is_Debug_Target_SNK	YES
RP_Value	Default
Type_C_Port_On_Hub	NO
Type_C_Power_Source	Both
Type_C_Sources_VCONN	NO
Type_C_Is_Alt_Mode_Controller	NO
Type_C_Is_Alt_Mode_Adapter	NO
Product_Total_Source_Power_mW	5000
Port_Source_Power_Type	Assured
Host_Supports_USB_Data	YES
Host_Speed	USB 2
Host_Contains_Captive_Retimer	NO
Host_Is_Embedded	YES
Host_Suspend_Supported	NO
Is_DFP_On_Hub	NO
Device_Supports_USB_Data	1
Device_Speed	USB 2
Device_Max_USB2_Speed	High Speed
Device_Contains_Captive_Retimer	NO
EPR_Supported_As_Src	NO
FR_Swap_Type_C_Current_Capability_As_Initial_Sink	FR_Swap not supported
Master_Port	YES
Has_Invariant_PDOs	YES
Port_Managed_Guaranteed_Type	Guaranteed Capability
EPR_Supported_As_Snk	NO
Accepts_PR_Swap_As_Src	YES
Accepts_PR_Swap_As_Snk	YES
Requests_PR_Swap_As_Src	NO
Requests_PR_Swap_As_Snk	NO
FR_Swap_Supported_As_Initial_Sink	NO
XID_SOP	0
Data_Capable_As_USB_Host_SOP	YES
Data_Capable_As_USB_Device_SOP	YES
Product_Type_UFP_SOP	PDUSB Peripheral
Product_Type_DFP_SOP	PDUSB Host
DFP_VDO_Port_Number	0
Modal_Operation_Supported_SOP	NO
USB_VID_SOP	344F
PID_SOP	0000
bcdDevice_SOP	0000
PD_Power_As_Source	5000
USB_Suspend_May_Be_Cleared	YES

Parameter	Vendor Info File
Sends_Pings	NO
Num_Src_PDOs	1 Src PDO
PD_OC_Protection	NO
PD_Power_As_Sink	18000
No_USB_Suspend_May_Be_Set	YES
GiveBack_May_Be_Set	NO
Higher_Capability_Set	NO
FR_Swap_Reqd_Type_C_Current_As_Initial_Source	FR_Swap not supported
Num_Snk_PDOs	2 Snk PDOs
Src_PDO_Supply_Type #1	Fixed
Src_PDO_Peak_Current #1	100% IOC
Src_PDO_Voltage #1	5000 mV
Src_PDO_Max_Current #1	1000 mA
Snk_PDO_Supply_Type #1	Fixed
Snk_PDO_Voltage #1	5000 mV
Snk_PDO_Op_Current #1	2000 mA
Snk_PDO_Supply_Type #2	Fixed
Snk_PDO_Voltage #2	9000 mV
Snk_PDO_Op_Current #2	2000 mA

Remark: All information is obtained from the VIF file provided by the customer

TC
3C
PPR
Report

3.4 Block Diagram Of Test Setup

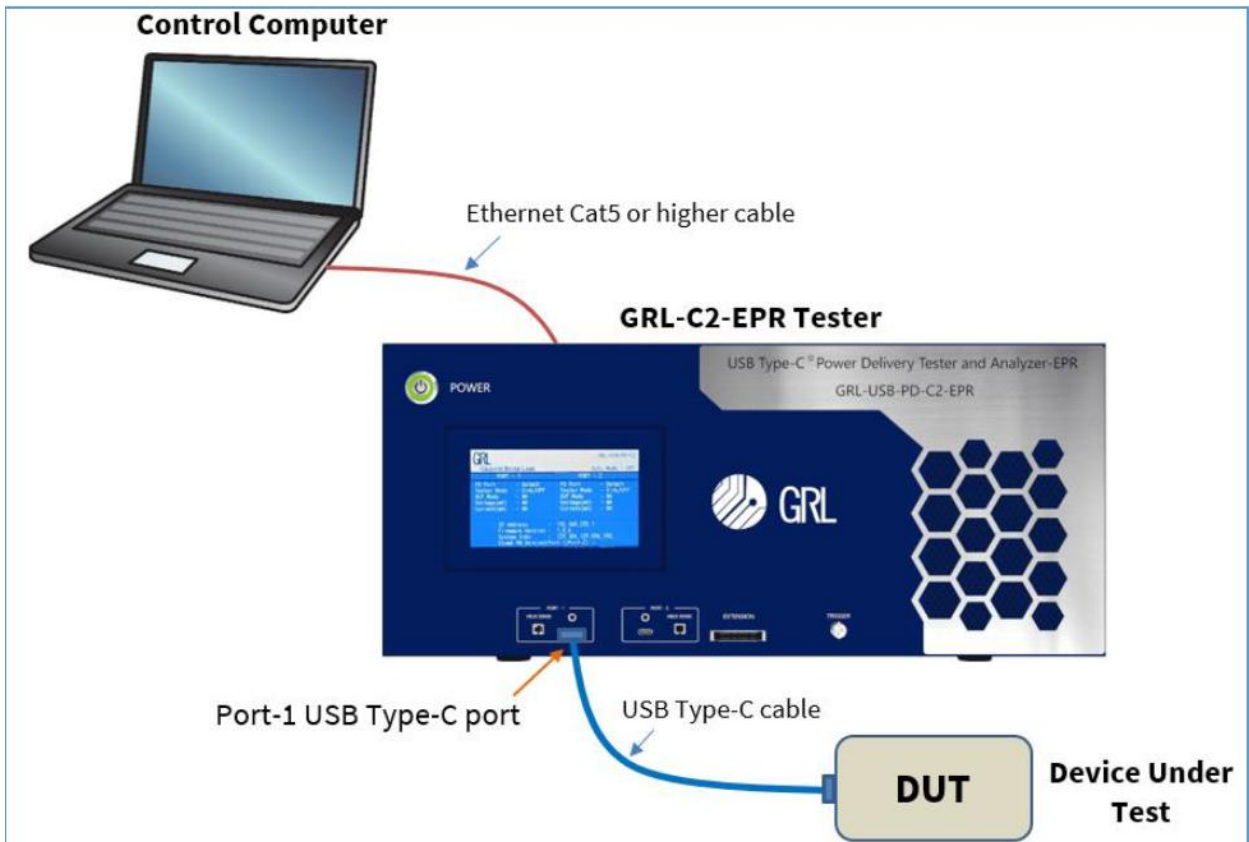

4. Test Facility And Test Instrument Used

4.1 Test Facility

All measurement facilities used to collect the measurement data are located at Shenzhen BCTC Testing Co., Ltd. Address: 1-2/F., Building B, Pengzhou Industrial Park, No.158, Fuyuan 1st Road, Zhancheng, Fuhai Subdistrict, Bao'an District, Shenzhen, Guangdong, China. The site and apparatus are constructed in conformance with the requirements of ANSI C63.4 and CISPR 16-1-1 other equivalent standards.

FCC Test Firm Registration Number: 712850

A2LA certificate registration number is: CN1212

ISED Registered No.: 23583

ISED CAB identifier: CN0017

4.2 Test Instrument Used

Radiated Emissions Test (966 Chamber01)					
Equipment	Manufacturer	Model#	Serial#	Last Cal.	Next Cal.
Test analyzer	GRL	GRL-USB-P D-C2-EPR	/	Sep. 13, 2024	Sep. 12, 2025
Software	GRL	GRL-C2 - Browser App	/	/	/

5. Functional Tests Result Summary

SI No	Test ID	Test Name	Result
1	TD.4.11.2	TD.4.11.2 Sink Dead Battery Test	PASS
2	TD.4.1.1	TD.4.1.1 Initial Voltage Test	PASS
3	TD.4.2.1	TD.4.2.1 Source Connect Sink Test	NA
4	TD.4.2.2	TD.4.2.2 Source Connect SNKAS Test	NA
5	TD.4.2.3	TD.4.2.3 Source Connect DRP	NA
6	TD.4.2.4	TD.4.2.4 Source Connect Try SRC DRP	NA
7	TD.4.2.5	TD.4.2.5 Source Connect Try SNK DRP	NA
8	TD.4.2.6	TD.4.2.6 Source Connect Audio Accessory	NA
9	TD.4.2.7	TD.4.2.7 Source Connect Debug Accessory	NA
10	TD.4.2.8	TD.4.2.8 Source Connect Vconn Accessory	NA
11	TD.4.3.1	TD.4.3.1 Sink Connect Source Test	NA
12	TD.4.3.2	TD.4.3.2 Sink Connect DRP Test	NA
13	TD.4.3.3	TD.4.3.3 Sink Connect Try SRC DRP Test	NA
14	TD.4.3.4	TD.4.3.4 Sink Connect Try SNK DRP Test	NA
15	TD.4.3.5	TD.4.3.5 Sink.Connect.SNKAS.Test	NA
16	TD.4.3.6	TD.4.3.6 Sink.Connect.Accessories.Test	NA
17	TD.4.4.1	TD.4.4.1 SNKAS Connect Source Test	NA
18	TD.4.4.2	TD.4.4.2 SNKAS Connect DRP Test	NA
19	TD.4.4.3	TD.4.4.3 SNKAS Connect Try SRC DRP Test	NA
20	TD.4.4.4	TD.4.4.4 SNKAS Connect Try SNK DRP Test	NA
21	TD.4.4.5	TD.4.4.5 SNKAS Connect SNKAS Test	NA
22	TD.4.4.6	TD.4.4.6 SNKAS Connect Audio Acc	NA
23	TD.4.4.7	TD.4.4.7 SNKAS Connect Debug Accessory	NA
24	TD.4.4.8	TD.4.4.8 SNKAS Connect PoweredAcc	NA
25	TD.4.5.1	TD.4.5.1 DRP Connect Sink Test	NA
26	TD.4.5.2	TD.4.5.2 DRP Connect SNKAS Test	NA
27	TD.4.5.3	TD.4.5.3 DRP Connect Source Test	NA
28	TD.4.5.4	TD.4.5.4 DRP Connect DRP Test	NA
29	TD.4.5.5	TD.4.5.5 DRP Connect Try SRC DRP Test	NA
30	TD.4.5.6	TD.4.5.6 DRP Connect Try SNK DRP Test	NA
31	TD.4.6.1	TD.4.6.1 Try SRC DRP Connect Source Test	NA
32	TD.4.6.2	TD.4.6.2 Try SRC DRP Connect DRP Test	NA
33	TD.4.6.3	TD.4.6.3 Try SRC DRP Connect Try SRC DRP Test	NA
34	TD.4.6.4	TD.4.6.4 Try SRC DRP Connect Try SNK DRP Test	NA
35	TD.4.6.5	TD.4.6.5 Try SRC DRP Connect Sink Test	NA
36	TD.4.6.6	TD.4.6.6 Try SRC DRP Connect SNKAS Test	NA
37	TD.4.7.1	TD.4.7.1 Try SNK DRP Connect Source Test	PASS
38	TD.4.7.2	TD.4.7.2 Try SNK DRP Connect DRP Test	PASS
39	TD.4.7.3	TD.4.7.3 Try SNK DRP Connect Try SRC DRP Test	PASS
40	TD.4.7.4	TD.4.7.4 Try SNK DRP Connect Try SNK DRP Test	PASS
41	TD.4.7.5	TD.4.7.5 Try SNK DRP Connect Sink Test	PASS

SI No	Test ID	Test Name	Result
42	TD.4.7.6	TD.4.7.6 Try SNK DRP Connect SNKAS Test	PASS
43	TD.4.8.1	TD.4.8.1 DRP Connect Audio Acc Test	PASS
44	TD.4.8.2	TD.4.8.2 DRP Connect Debug Acc Test	PASS
45	TD.4.8.3	TD.4.8.3 DRP Connect Vconn Accessory Test	PASS
46	TD.4.9.1	TD.4.9.1 Source Suspend Test	NA
47	TD.4.9.2	TD.4.9.2 USB Type C Current Advertisement Test	PASS
48	TD.4.9.3	TD.4.9.3 Source PR Swap Test	PASS
49	TD.4.9.4	TD.4.9.4 Source Vconn Swap Test	NA
50	TD.4.9.5	TD.4.9.5 Source Alternate Mode Test	NA
51	TD.4.10.1	TD.4.10.1 Sink Power Sub States Test	FAIL
52	TD.4.10.2	TD.4.10.2 Sink Power Precedence Test	PASS
53	TD.4.10.3	TD.4.10.3 Sink Suspend Test	PASS
54	TD.4.10.4	TD.4.10.4 Sink PR Swap Test	PASS
55	TD.4.10.5	TD.4.10.5 Sink.VCONN Swap Test	NA
56	TD.4.10.6	TD.4.10.6 Sink Alternate Mode Test	PASS
57	TD.4.11.1	TD.4.11.1 DR Swap Test	PASS
58	TD.4.12.2	TD.4.12.2 Hub Port Types Test	NA
59	TD.4.1.2	TD.4.1.2 Unpowered CC Voltage Test	NA
60	TD.4.13.5	TD.4.13.5 Cable EnterUSB and Data Reset Test	NA

Note: "N/A" according VIF file this case in not required test.

Please refer to Appendix < Appendix for Report No. BCTC2504902986-2E > for details.

SHENZHEN

6. EUT Photographs

EUT Photo 1

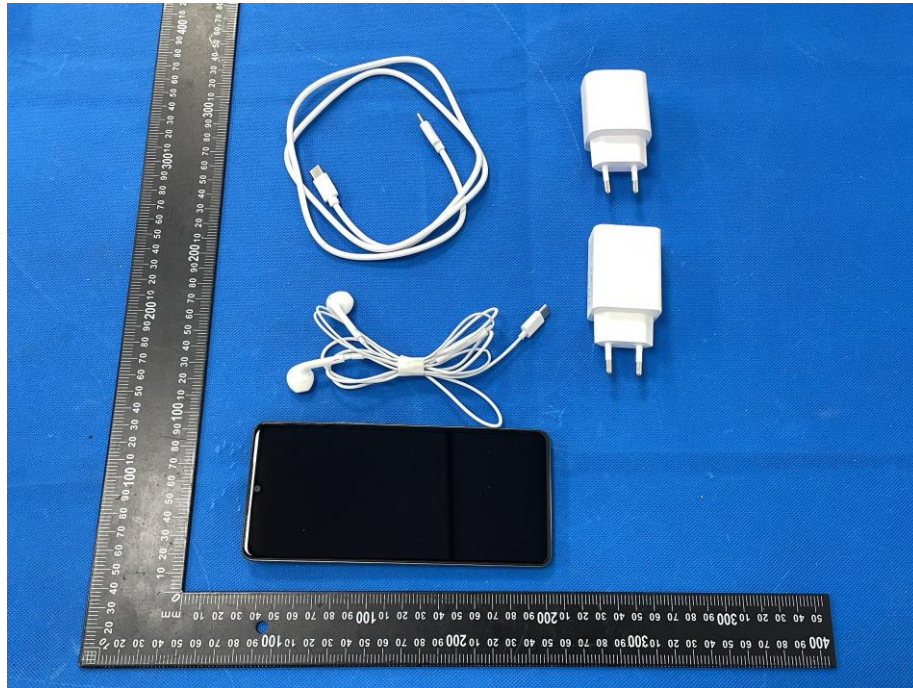

EUT Photo 2



EUT Photo 3



EUT Photo 4

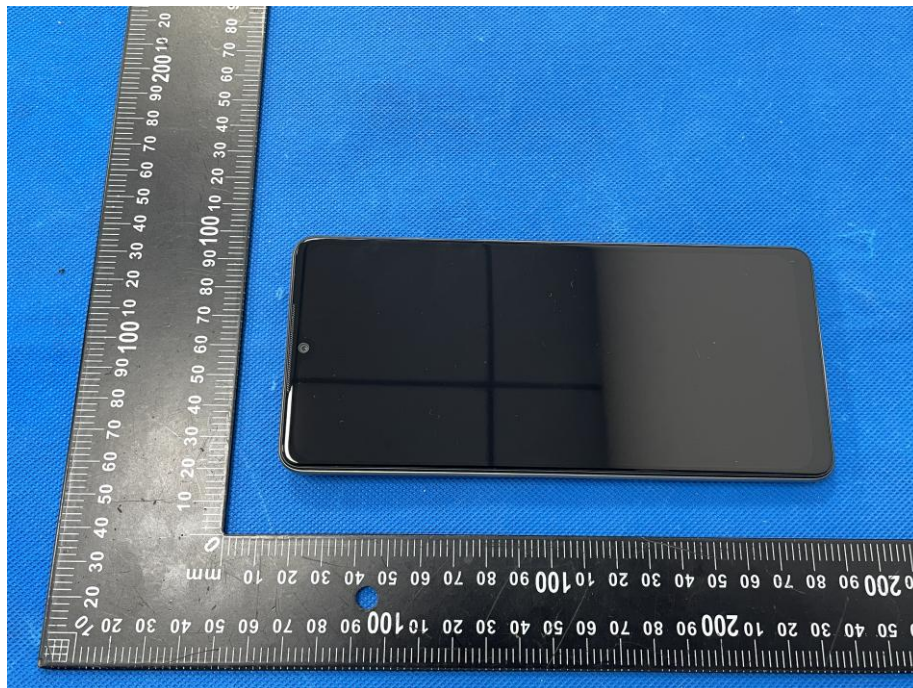

NOTE: Appendix-Photographs Of EUT Constructional Details.

7. EUT Test Setup Photographs



STATEMENT

1. The equipment lists are traceable to the national reference standards.
2. The test report can not be partially copied unless prior written approval is issued from our lab.
3. The test report is invalid without the "special seal for inspection and testing".
4. The test report is invalid without the signature of the approver.
5. The test process and test result is only related to the Unit Under Test.
6. Sample information is provided by the client and the laboratory is not responsible for its authenticity.
7. The quality system of our laboratory is in accordance with ISO/IEC17025.
8. If there is any objection to this test report, the client should inform issuing laboratory within 15 days from the date of receiving test report.

Address:

1-2/F., Building B, Pengzhou Industrial Park, No.158, Fuyuan 1st Road, Zhancheng, Fuhai Subdistrict, Bao'an District, Shenzhen, Guangdong, China

TEL: 400-788-9558

P.C.: 518103

FAX: 0755-33229357

Website: <http://www.chnbctc.com>

Consultation E-mail: bctc@bctc-lab.com.cn

Complaint/Advice E-mail: advice@bctc-lab.com.cn

***** END *****

ing
CO., LTD